

STAR OBJECTS

FIRST FLOOR



★ **William Smith's Map**
Created in 1815 by William 'Strata' Smith, this represents the first complete geological map of this country.

★ **The Towton Torcs**

GROUND FLOOR

ROMAN YORK: MEET THE PEOPLE OF THE EMPIRE



★ **Statue of Mars**
This stunning life-size statue of Mars is one of the best preserved pieces of sculpture from Roman Britain.

★ **Roman Head Pot**

★ **Mithras Plaque**

EXTINCT: A WAY OF LIFE



★ **The Middlesbrough Meteorite**
The Middlesbrough Meteorite hit the earth in 1881. It is about 4.5 billion years old and was formed at the same time as the earth and the solar system.

★ **Moa**

★ **Ichthyosaur**

BASEMENT

MEDIEVAL YORK: CAPITAL OF THE NORTH



★ **Middleham Jewel**

★ **Escrick Ring**

★ **York Boar Badge**

★ **Tau Pendant**

Yorkshire Museum

MAP OF THE MUSEUM





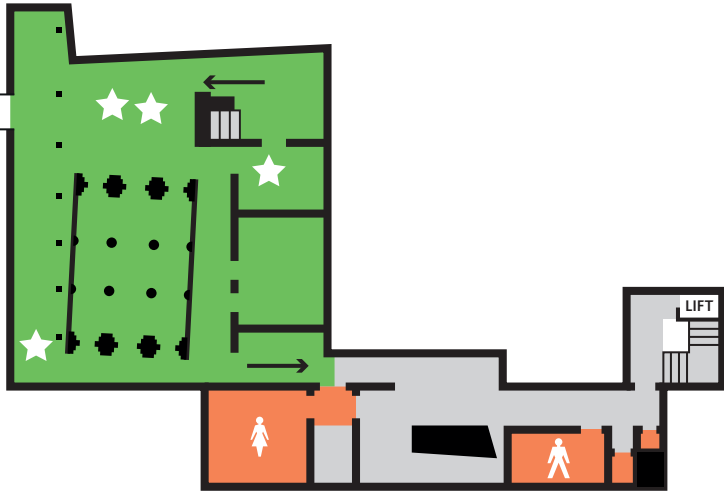

ROMANS VIKINGS MEDIEVAL EXTINCT

York Museums Trust

Yorkshire Museum







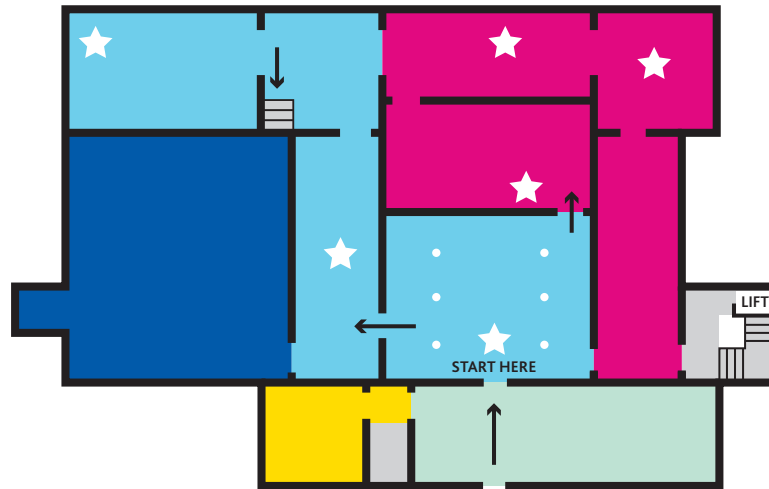

BASEMENT

-  Medieval York: Capital of the North
-  Female Toilets
-  Male Toilets
-  Accessible Toilet and Baby Change
-  Star Objects



GROUND FLOOR

-  Entrance and Shop
-  Roman York: Meet the People of the Empire
-  Extinct: A Way of Life
-  Conference Space
-  School Lunch Space
-  Star Objects

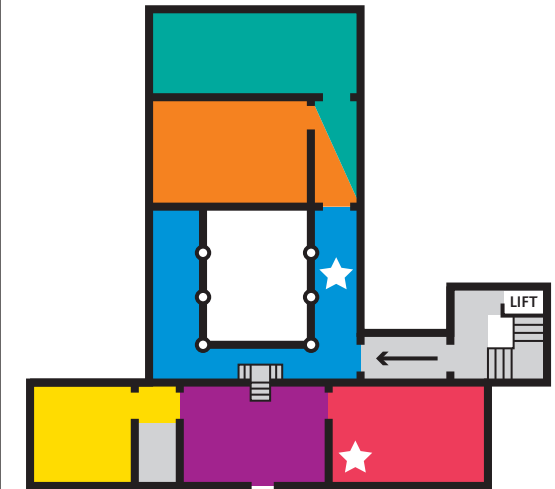

FIRST FLOOR

-  After the Ice: Yorkshire's Prehistoric People
-  Finds Lab
-  Science Lab
-  The Story of the Rocks: William 'Strata' Smith
-  Library
-  School Lunch Space
-  Star Objects